

REV	E.C.N NO.	CONTENT	CHK	DATE
V0.2	S2309004	Add VDE and UL Logo	ZZW	2023.09.25

NOTES:

1. UL:

Rating:300V, 12A;  
 Insulation Withstands Voltage:AC1600V/MIN;  
 Suitable Electric Wire:28AWG~16AWG  
 Using Temperature Range:-40°C~+130°C;

2. IEC:

Rating:630V, 17.5A;  
 Rate Impulse Voltage:6000V;  
 Insulation Resistance:500MΩ or more at DC500V;  
 Contact Resistance: ≤5mΩ

Material Group:IIIa;

Pollution Degree:2;

Overtoltage Category:III;

Suitable Electric Wire:0.2mm<sup>2</sup>~1.5mm<sup>2</sup>

Using Temperature Range:-40°C~+120°C;  
 3.Strip length:8.0~9.0mm

4.RoHS compliance;

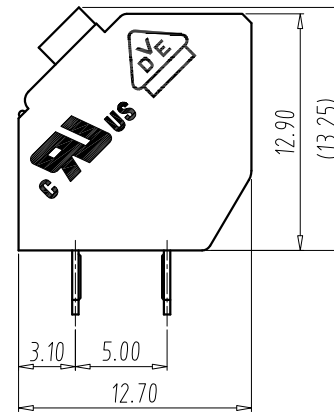
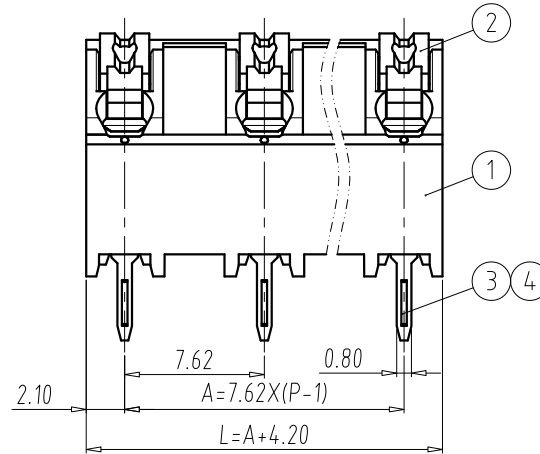
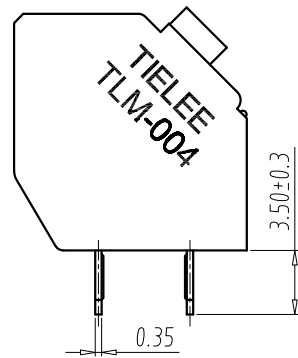
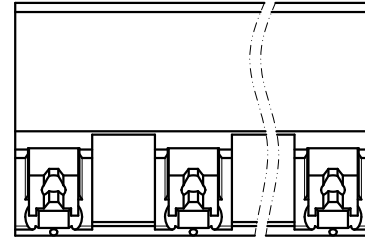
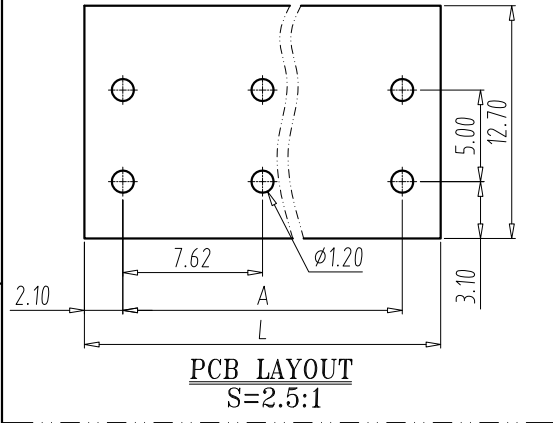

DIM	P	2	3	4	5	6	7	8
A		7.62	15.24	22.86	30.48	38.1	45.72	53.34
L		11.82	19.44	27.06	34.68	42.3	49.92	57.54

DIM	P	9	10	11	12	13	14	15	16
A		60.96	68.58	76.2	83.82	91.44	99.06	106.68	114.3
L		65.16	72.78	80.4	88.02	95.64	103.26	110.88	118.5

Total Pitch Tolerances in mm																Nominal dimension range in mm															
over	over	over	over	over	over	over	over	over	over	over	over	over	over	over	over	over	over	over	over	over	over	over	over	over	over	over	over	over	over		
0	30	53	70	90	115	150	200	250	300	350	400	450	500	550	600	0	30	53	70	90	115	150	200	250	300	350	400	450	500	550	
to	to	to	to	to	to	to	to	to	to	to	to	to	to	to	to	to	to	to	to	to	to	to	to	to	to	to	to	to	to	to	
30	53	70	90	115	150	200	250	300	350	400	450	500	550	600	30	53	70	90	115	150	200	250	300	350	400	450	500	550	600		
±0.20	±0.25	±0.3	±0.35	±0.44	±0.55	±0.70	±0.85	±1.00	±0.25	±0.30	±0.35	±0.44	±0.55	±0.70	±0.80	±0.90	±1.20														

4	SOLDER PIN	P	H-Copper Alloy	Tin Plated
3	SPRING	P	Stainless	/
2	LEVER	P	PA-HT	UL94 V-0
1	HOUSING	1	PA-HT	UL94 V-0

DWG.	YHZ	DATE	2022.05.28	UNITS	MM	SHEET/OF	1/1
CHK.		DATE		SCALE	2.5 : 1	A4	
APP.		DATE		NAME TLM-004AT-7.62-XXP(X) DWGNO. TLDW-TLM004AT7.62XXP(X)			