

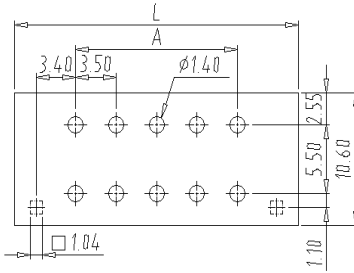

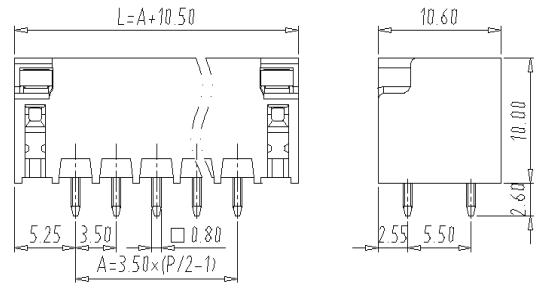

PCB Connector — TLP series (Pin header)— TLPHDW-010V

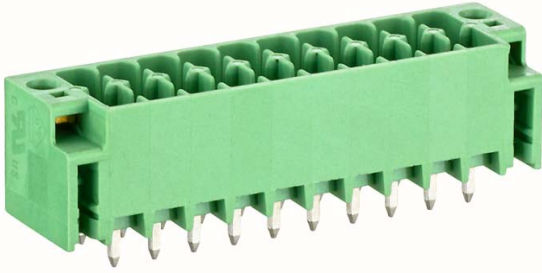

■ 图示(Pic. shown) : TLPHDW-010V-20P-G26

General. PCB Connector Rated : 160V,10A
Single row ,3.50mm pitch , 04-48 Pole
Orientation:90°(plug-in to board)

认证 (Approval)   

■ 技术参数 Technical Data	UL standard			IEC standard		
	UL应用组别(UL Application group)	UL Application group			IEC过电压别/污染等级(IEC overvoltage category /pollution degree)	
IEC过电压别/污染等级(IEC overvoltage category /pollution degree)	B	C	D	III / 3	III / 2	II / 2
额定电压(Rated voltage)	300V	50V	--	160V	160V	320V
额定电流(Rated current)	8A	8A	--	10A	10A	10A
额定连接容量(Rated connection capacity)	--			--		
绝缘材料(Insulation Material)	PA66 UL94 V-0					
绝缘材料组别(Material group)	IIla					
电流承载部件材料和镀层(Material & Plating of Current carrier)	Copper alloy , Tin plated					
接线弹片材料(Material of Clamp spring)	--					
耐电压(1分钟)(Withstanding Voltage/1Min)	1600V					
额定冲击电压(Rated surge voltage)	2500V					
接线螺丝(Wire clamp unit Screw) , 最大扭矩(torque Max.)	--					
固定螺丝(Mounting Screw) , 扭矩(torque)	--					
剥线长度(Wire stripping length)	--					
使用温度(Operating temperature)	-40°C up to +115°C(UL) / -40°C up to +120°C(IEC)					
存储温度(Storage temperature)	-40°C up to +70°C					
存储相对湿度(Storage relative humidity)	≤70%					
焊接方式(Soldering recommend)	Wave soldering ,260°C 8S Max					

■ 订购方式(How to order)

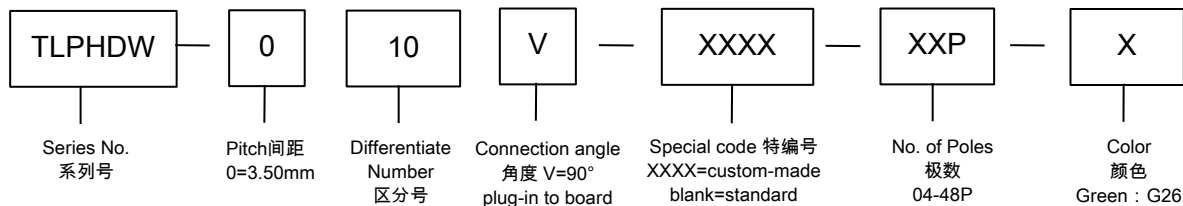

■ 插头 (Female Connector) — dual row in 1 plane



P/N : TLPSDW-010
Wiring orientation :
180°(wire to plug-in)
Rated : 160V,10A , 1.5mm²

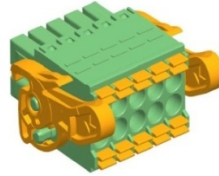

P/N : TLPSDL-010
Wiring orientation :
180°(wire to plug-in)
Rated : 160V,10A , 1.5mm²